

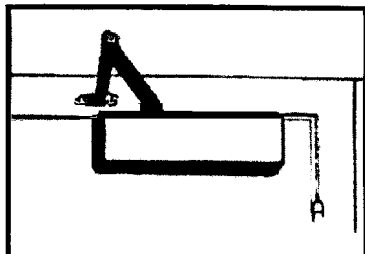

**C.R. LAURENCE CO., INC.**  
 Phone Toll Free (800) 421-8144  
 Fax Toll Free (800) 262-3299  
 Locations to serve the Industries  
 Throughout North America & Europe  
 Website Address: [www.crlaurence.com](http://www.crlaurence.com)

# PR90 SERIES DOOR CLOSER INSTALLATION INSTRUCTIONS

## REGULAR MOUNT (PULL SIDE)



## TOP JAMB MOUNT (PUSH SIDE)

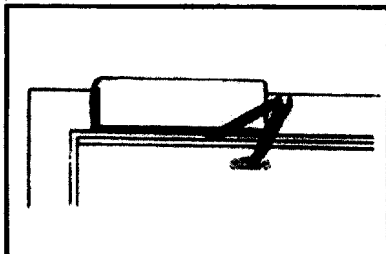

## PARALLEL MOUNT (PUSH SIDE)

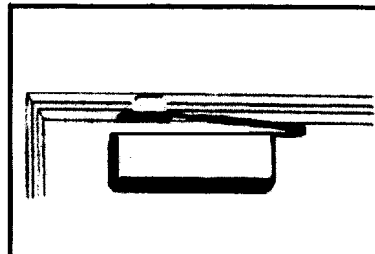

| MAXIMUM<br>DOOR WIDTH |                   | FULL<br>TURNS<br>REQUIRED |
|-----------------------|-------------------|---------------------------|
| EXTERIOR<br>DOORS     | INTERIOR<br>DOORS |                           |
| —                     | 5 lb-f*           | 5 TURNS C.C.W.            |
| 8.5 lb-f*             | 34" (864)         | 2 TURNS C.C.W.            |
| 30" (762)             | 38" (962)         | 0 TURNS                   |
| 36" (914)             | 48" (1219)        | 5 TURNS C.W.              |
| 42" (1067)            | 54" (1372)        | 10 TURNS C.W.             |
| 48" (1219)            | 60" (1524)        | 15 TURNS C.W.             |

## HOW TO DETERMINE HAND OF DOOR

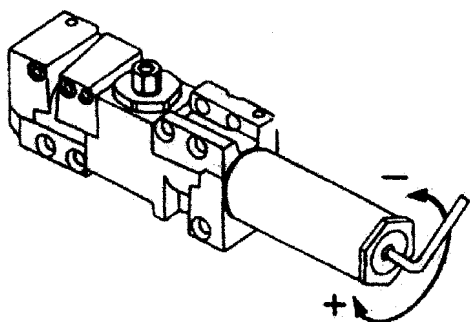

**Spring Power  
Adjustment**

## CONTROL RANGE

Delayed Action

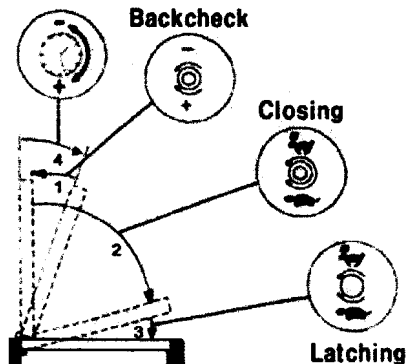

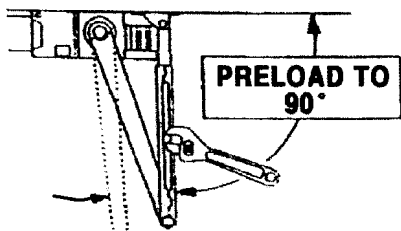
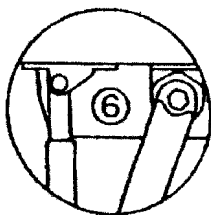
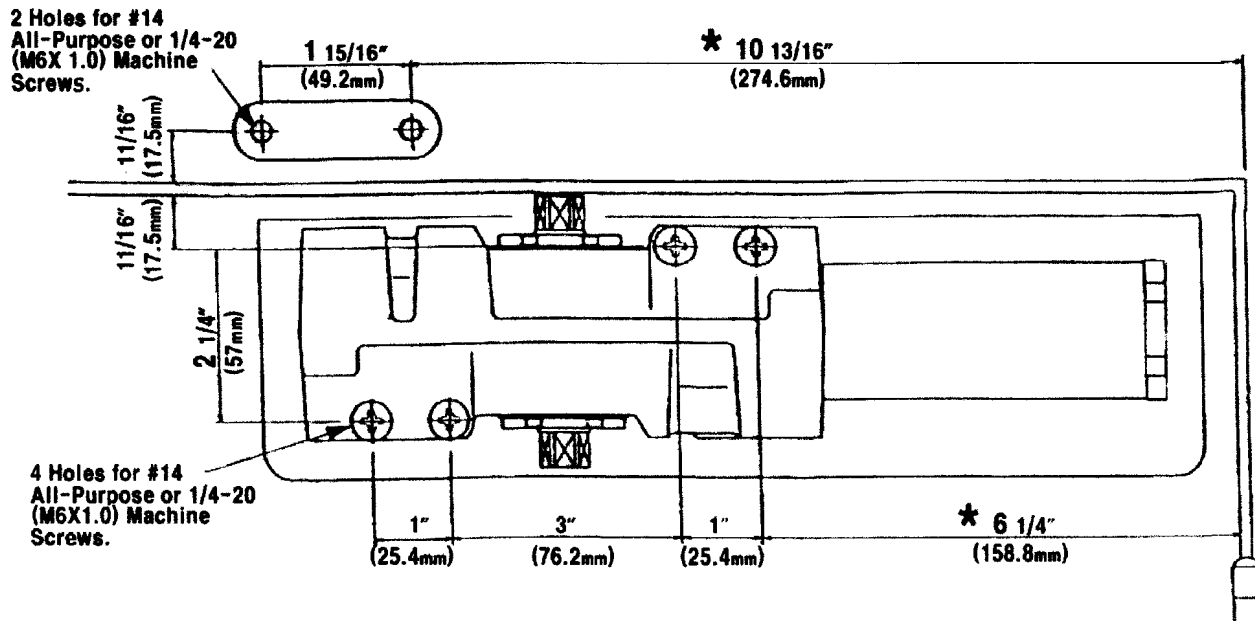

**NOTE : DOOR OPENINGS TO 120° - CONDITIONS PERMITTING.**

1. Adjust spring power to match door width as indicated by chart on front page.
2. Mount closer on door as dimensions shown. Tube end toward hinge. If pivots are used, locate closer and shoe from CENTERLINE OF PIVOT. (For offset pivots, increase the marked dimensions by 1/8")
3. Place main arm on top of shaft, 100° to closer body, insert arm screw into top of shaft and tighten.
4. Attach shoe to frame as shown. (If more latching power is required, rotate shoe 180°.)
5. Open door and insert rod in forearm.
6. With forearm at right angle to door (90°), insert forearm set screw and tighten. (IF HOLD OPEN ARM IS USED, THE NUT IS ON THE TOP FOR RH DOOR AND BOTTOM FOR LH DOOR)

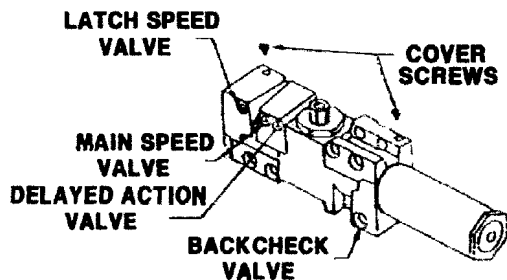

### REGULATION:

A 'Normal' closing time from 90° open position to door stop position is 4-6 secs, evenly divided between main swing speed and latch swing speed. Use hex key (furnished) to adjust speed. To slow main speed of door, turn regulating valve nearest shaft clockwise. To slow latch speed, turn regulating valve nearest hinge clockwise.

### BACKCHECK

To increase backcheck force, turn regulating valve nearest hinge clockwise. **DO NOT USE ABRUPT BACKCHECK OR EXPECT DOOR CLOSER TO ACT AS A DOOR STOP.**

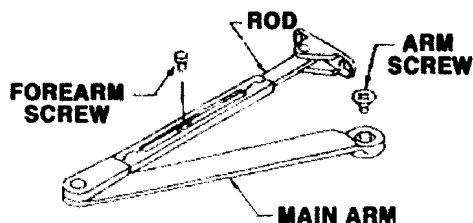

### COVER

Place insert in proper cutout, then push cover against door frame. Tighten both cover screws securely.

### HOLD OPEN ADJUSTMENT (When hold open arm is used)

Loosen adjusting nut, open door to desired hold open position tighten nut. Do not permit door to swing while hold open is set.

## PARALLEL ARM INSTALLATION CLOSER MOUNTED ON PUSH SIDE OF DOOR

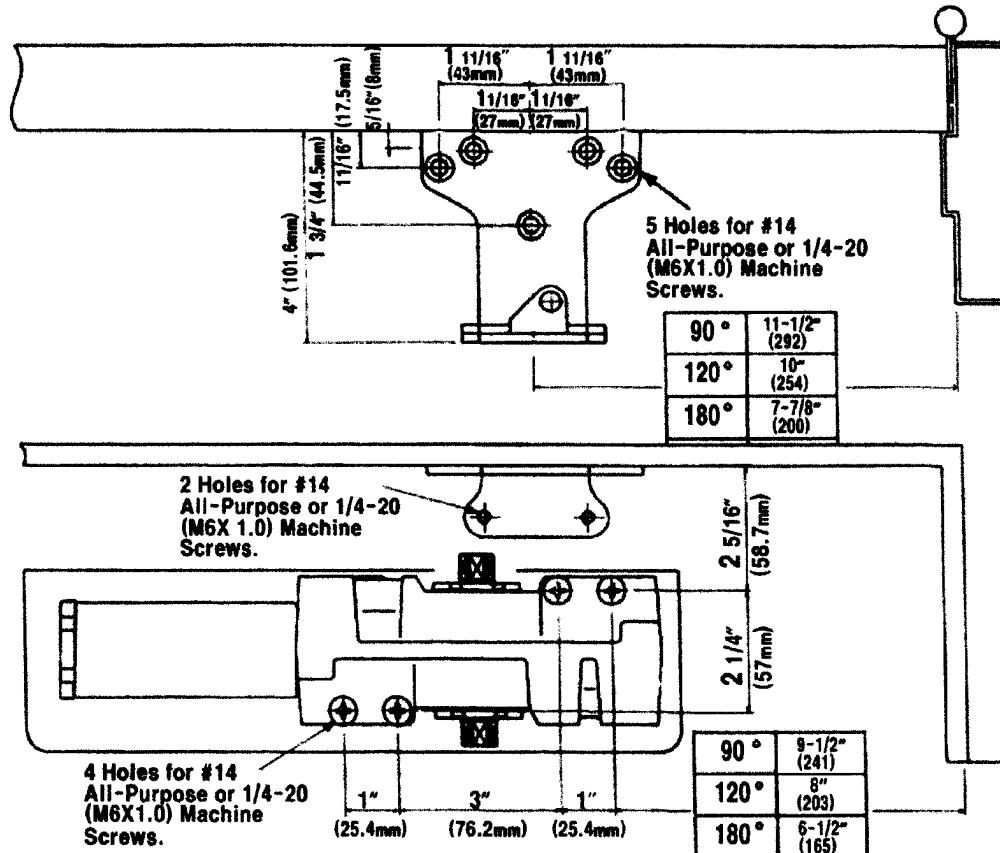

**NOTE : DOOR OPENINGS TO 180° - CONDITIONS PERMITTING.**

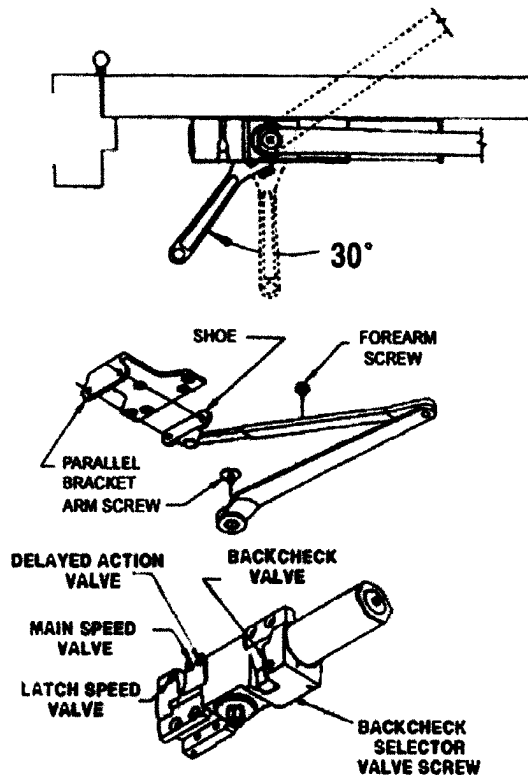

1. Before installation, (parallel arm), turn Backcheck selector valve (found on the opposite side of closer) ALL THE WAY IN (CLOCKWISE).
  2. Adjust spring power to match door width as indicated by chart on front page.
  3. Mount closer on door as dimensions shown. Tube end toward latch. If pivots are used, locate closer and parallel bracket from CENTERLINE OF PIVOT.
  4. Place open end wrench on bottom shaft and turn toward hinge jamb about 30° and then place main arm on top shaft, insert arm screw into top of shaft and tighten.
  5. Attach parallel bracket on frame as dimensions shown.
  6. Attach rod and shoe to parallel bracket as shown.
  7. Insert rod in forearm, and then insert main arm to closer parallel to door. Then insert forearm set screw and tighten.
- ( IF HOLD OPEN ARM IS USED, THE NUT IS ON THE TOP FOR RH DOOR AND BOTTOM FOR LH DOOR )

### REGULATION:

A 'Normal' closing time from 90° open position to door stop position is 4-6 secs, evenly divided between main swing speed and latch swing speed. Use hex key (furnished) to adjust speed. To slow main speed of door, turn regulating valve nearest shaft clockwise. To slow latch speed, turn regulating valve nearest hinge clockwise.

### BACKCHECK

To increase backcheck force, turn regulating valve nearest hinge clockwise. **DO NOT USE ABRUPT BACKCHECK OR EXPECT DOOR CLOSER TO ACT AS A DOOR STOP.**

### COVER

Place insert in proper cutout, then push cover against door frame. Tighten both cover screws securely.

### HOLD OPEN ADJUSTMENT (When hold open arm is used)

Loosen adjusting nut, open door to desired hold open position tighten nut. Do not permit door to swing while hold open is set.



**C.R. LAURENCE CO., INC.**  
 Phone Toll Free (800) 421-6144  
 Fax Toll Free (800) 262-3299  
 Website Address :www.crlaurence.com

## TOP JAMB INSTALLATION CLOSER MOUNTED ON PUSH SIDE OF DOOR

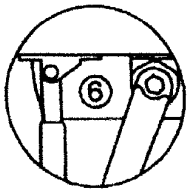
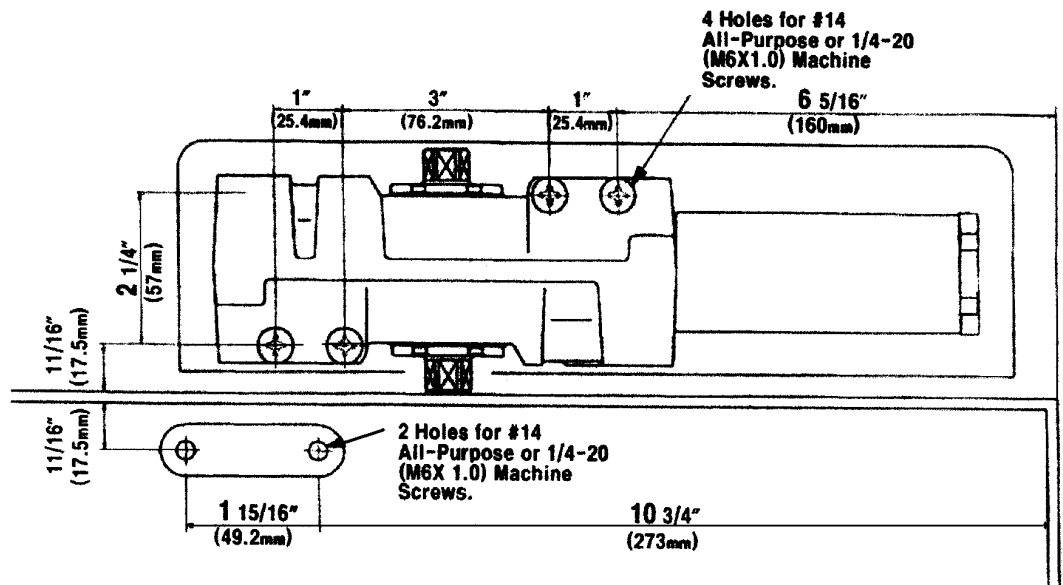

**NOTE : DOOR OPENINGS TO 120°- CONDITIONS PERMITTING.**

1. Adjust spring power to match door width as indicated by chart on front page.
2. Mount closer on door as dimensions shown. Tube end toward hinge. If pivots are used, locate closer and shoe from CENTERLINE OF PIVOT.  
(For offset pivots, increase the marked dimensions by 1/8")
3. Place main arm on top of shaft, 100° to closer body, insert arm screw into top of shaft and tighten.
4. Attach shoe to frame as shown. (If more latching power is required, rotate shoe 180°.)
5. Open door and insert rod in forearm. - For reveals of 2-7/16"-4-5/8", use optional Extended Arm Rod No. PR90AXT.
6. With forearm at right angle to door (90°), insert forearm set screw and tighten.  
(IF HOLD OPEN ARM IS USED, THE NUT IS ON THE TOP FOR RH DOOR AND BOTTOM FOR LH DOOR)

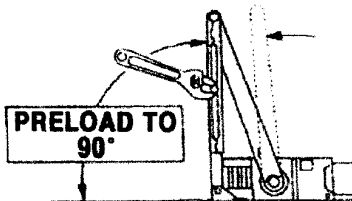

### REGULATION:

A 'Normal' closing time from 90° open position to door stop position is 4-6 secs, evenly divided between main swing speed and latch swing speed. Use hex key (furnished) to adjust speed. To slow main speed of door, turn regulating valve nearest shaft clockwise. To slow latch speed, turn regulating valve nearest hinge clockwise.

### BACKCHECK

To increase backcheck force, turn regulating valve nearest hinge clockwise. DO NOT USE ABRUPT BACKCHECK OR EXPECT DOOR CLOSER TO ACT AS A DOOR STOP.

### COVER

Place insert in proper cutout, then push cover against door frame. Tighten both cover screws securely.

### HOLD OPEN ADJUSTMENT (When hold open arm is used)

Loosen adjusting nut, open door to desired hold open position tighten nut. Do not permit door to swing while hold open is set.

